



**INDUCTION MOTORS**

Frame size 80mm sq. (3.15 in. sq.)

Single-Phase, Three-Phase

**25W (1/30 HP)**

LEAD WIRE TYPE

**DIMENSIONS**

**SPEED-TORQUE CURVE**

Unit : mm(inch)

**E8125P□L**

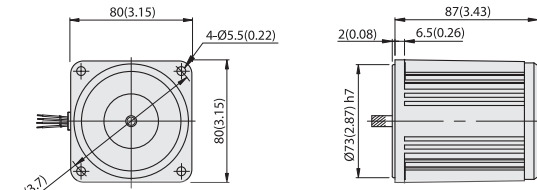

WEIGHT 1.5kg (3.3 lb)

**E8125□**

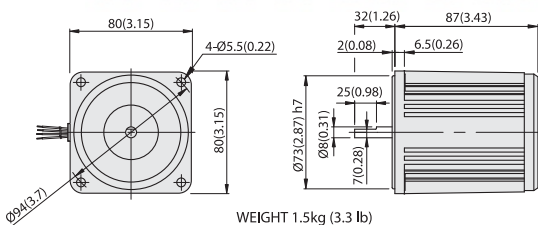

WEIGHT 1.5kg (3.3 lb)

Single phase E8125□□

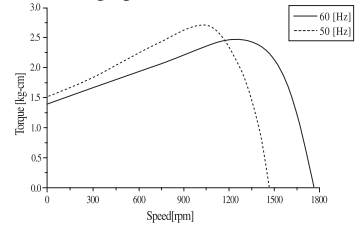

Three phase E8125□□

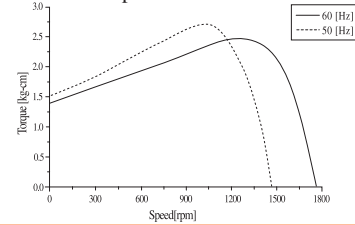

**CONNECTION DIAGRAMS (4-lead wire type)**

**CONNECTION DIAGRAMS (3-lead wire type)**

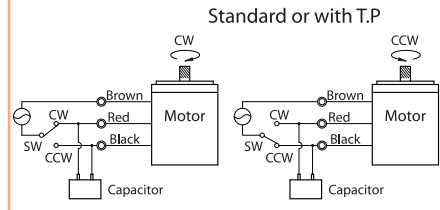
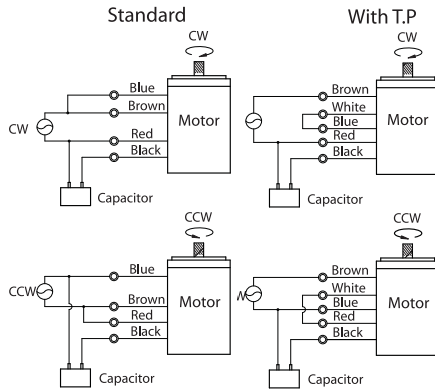

**CONNECTION DIAGRAMS (3 phase)**

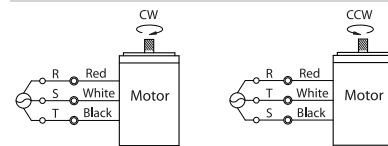

**SPECIFICATIONS**

CONTINUOUS DUTY, INSULATION CLASS A or E, 4POLES

The direction of rotation is seen from the end of motor shaft.

Model	Output		Voltage (V)	Frequency (Hz)	Rated						Starting Torque			Capacitor (µF)
	(HP)	(W)			Input (W)	Current (A)	Torque (kg-cm, N-m)		Speed (rpm)	(kg-cm)	(N-m)	(oz-in)		
E8125□C	1/30	25	1Ø100	50	60	0.57	1.95	0.191	27.08	1250	1.25	0.123	17.36	6
				60	60	0.52	1.6	0.157	22.22	1550	1.25	0.123	17.36	
E8125□D	1/30	25	1Ø200	50	60	0.28	1.95	0.191	27.08	1250	1.45	0.142	20.14	1.8
				60	60	0.28	1.6	0.157	22.22	1550	1.45	0.142	20.14	
E8125□B	1/30	25	1Ø220	60	65	0.3	1.6	0.157	22.22	1550	1.6	0.157	22.22	1.5
E8125□E	1/30	25	1Ø115	60	60	0.55	1.6	0.157	22.22	1550	1.2	0.118	16.66	4
E8125□X	1/30	25	1Ø220~240	50	60	0.25	1.95	0.191	27.08	1300	1.25	0.123	17.36	1.5
E8125□U	1/30	25	3Ø200	50	70	0.26	1.9	0.186	26.39	1250	5.9	0.578	81.93	-
				60	70	0.24	1.6	0.157	22.22	1550	4.7	0.461	65.27	
E8125□T	1/30	25	3Ø200~230	50	70	0.3	1.85	0.181	25.69	1350	7.7	0.755	106.93	-
				60	70	0.25	1.55	0.152	21.52	1600	6.1	0.598	84.71	
E8125□S	1/30	25	3Ø380~415	50	70	0.27	1.85	0.181	25.69	1350	7.7	0.755	106.93	-
				60	70	0.23	1.55	0.152	21.52	1600	6.1	0.598	84.71	
E8125□R	1/30	25	3Ø440	50	70	0.16	1.85	0.181	25.69	1350	7.7	0.755	106.93	-
				60	70	0.12	1.55	0.152	21.52	1600	6.1	0.598	84.71	

\*Model in grey screen represents the motors with THERMALLY PROTECTED according to UL regulation.

\*Model in dark grey screen represents the motors with THERMALLY PROTECTED according to CE regulation.

\*In case of some models certificated for export, the special cord like CE or UL is added after the existing model no. ex) E91601 DXH-CE, E91601 IEH-UL.

\*Insulation class for motors which acquired certificates for export is B.



**GEARHEADS**

Frame size 80mm sq. (3.15 in. sq.)

METAL TYPE & BALL BEARING TYPE

**DIMENSIONS**

**DECIMAL GEARHEAD**

**GEARHEAD**

Unit : mm(inch)

**E8G10D**

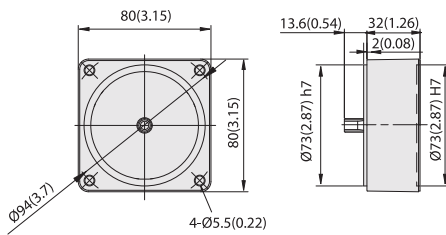

WEIGHT 0.4kg(0.88 lb)

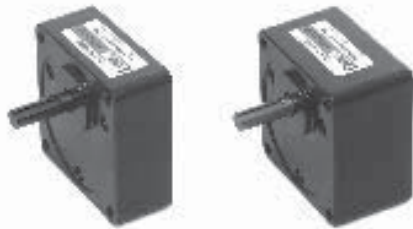

**E8HK□M(B)**

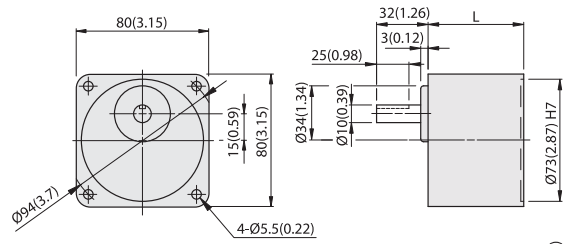

GEAR RATIO	L		WEIGHT		BOLT
	mm	in	kg	lb	
1/3~1/18	32	1.26	0.5	1.1	M5x50
1/20~1/200	46	1.81	0.7	1.5	M5x65

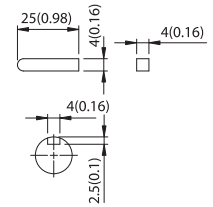

KEY SIZE



**E8HK□M(B) + E8I25P□L**

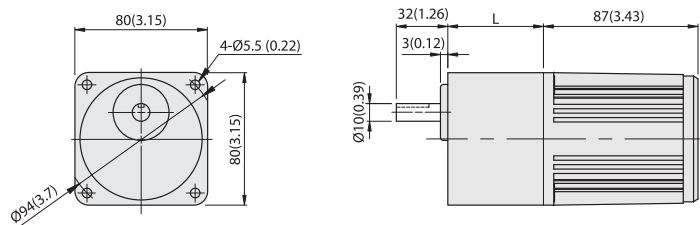

**RATED TORQUE OF GEARHEAD**

[www.MuGuL.com](http://www.MuGuL.com)

MODEL	Speed(rpm)	500	300	200	120	100	60	50	30	20	15	10	9	
		Ratio	50Hz	3	5	7.5	12.5	15	25	30	50	75	100	150
		60Hz	3.6	6	9	15	18	30	36	60	90	120	180	200
<b>E8HK□M</b> <b>E8HK□B</b>		kg-cm	4.7	7.9	11.8	19.7	23.7	35.6	42.7	64.4	80	80	80	80
		N-m	0.46	0.77	1.16	1.93	2.32	3.49	4.19	6.31	7.84	7.84	7.84	7.84
		oz-in	66	110	165	274	329	494	593	894	1111	1111	1111	1111

- \* The normal torque is that the motor and gearhead are directly coupled.
- \* Insert the denominator of reduction ratio in □ of gearhead model name.
- \* Actual rotation speed is 2~15% less than synchronous speed.
- \*   Color indicates that the rotation of gearhead shaft is in opposite direction as output shaft of motor.