



**BRAKE MOTORS**

Frame size 90mm sq. (3.54 in. sq.)

Single-Phase, Three-Phase

LEAD WIRE TYPE

**40W (1/18.5 HP)**

**DIMENSIONS**

**SPEED-TORQUE CURVE**

Unit : mm(inch)

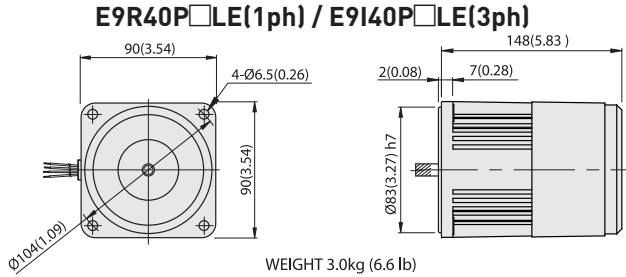

Single phase E9R40□□LE

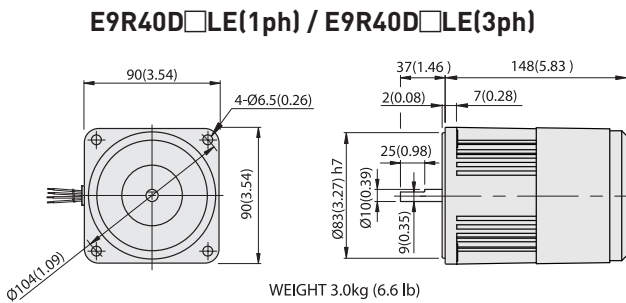
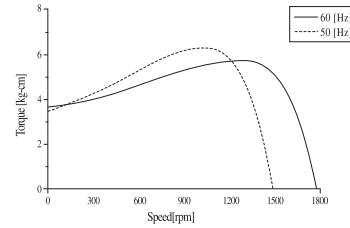

Three phase E9I40□□LE

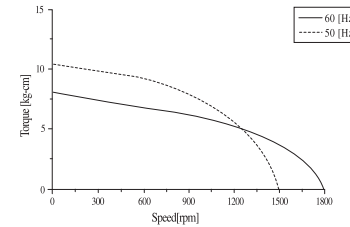

**CONNECTION DIAGRAMS**

www.MuGuL.com Standard or with T.P

Single Phase

Three Phase

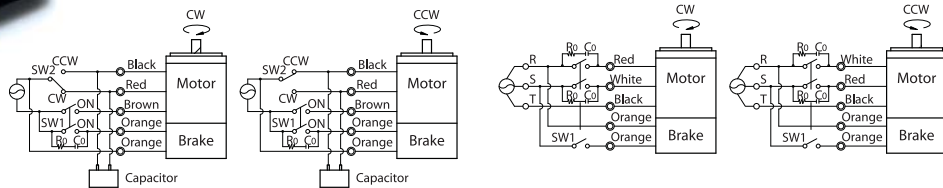

**SPECIFICATIONS**

The direction of rotation is seen from the end of motor shaft.

30 MIN. DUTY (only 3Ø, CONTINUOUS DUTY), INSULATION CLASS A or E, 4POLES

Model	Output		Voltage (V)	Frequency (Hz)	Rated				Starting Torque			Magnetic Brake			Capacitor (µF)			
	(HP)	(W)			Input (W)	Current (A)	Torque (kg-cm) (N-m) (oz-in)		Speed (rpm)	(kg-cm) (N-m) (oz-in)		Torque (kg-cm) (N-m) (oz-in)		Current (A)				
E9R40□CLE	1/18.5	40	1Ø100	50	110	0.91	3	0.294	41.66	1300	2.8	0.274	38.88	10	0.980	138.87	0.11	15
E9R40□DLE	1/18.5	40	1Ø200	50	110	0.46	3	0.294	41.66	1300	2.8	0.274	38.88	10	0.980	138.87	0.11	4
E9R40□BLE	1/18.5	40	1Ø220	60	120	0.54	2.5	0.245	34.72	1600	2.8	0.274	38.88	10	0.980	138.87	0.11	4
E9R40□ELE	1/18.5	40	1Ø115	60	110	1.0	2.5	0.245	34.72	1600	2.8	0.274	38.88	10	0.980	138.87	0.11	12
E9R40□XLE	1/18.5	40	1Ø220-240	50	110	0.52	3	0.294	41.66	1300	3.4	0.333	47.22	10	0.980	138.87	0.11	3.5
E9I40□ULE	1/18.5	40	2Ø200	50	100	0.33	3	0.294	41.66	1300	8.75	0.858	121.51	10	0.980	138.87	0.11	-
E9I40□TLE	1/18.5	40	2Ø220	50	100	0.38	2.9	0.284	40.27	1350	11	1.078	152.76	10	0.980	138.87	0.11	-
E9I40□TLE	1/18.5	40	2Ø220	60	100	0.32	2.6	0.255	36.11	1550	6.5	0.637	90.27	10	0.980	138.87	0.11	-

\* Model in grey screen represents the motors with THERMALLY PROTECTED according to UL regulation.

\* Model in dark grey screen represents the motors with THERMALLY PROTECTED according to CE regulation.

## GEARHEADS

Frame size 90mm sq. (3.54 in. sq.)

METAL TYPE & BALL BEARING TYPE

### DIMENSIONS

Unit : mm(inch)

#### DECIMAL GEARHEAD

##### E9G10D

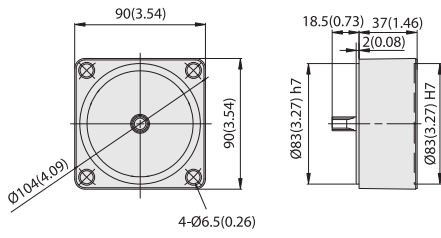

WEIGHT 0.6kg (1.3 lb)



#### GEARHEAD

##### E9HK□M(B)

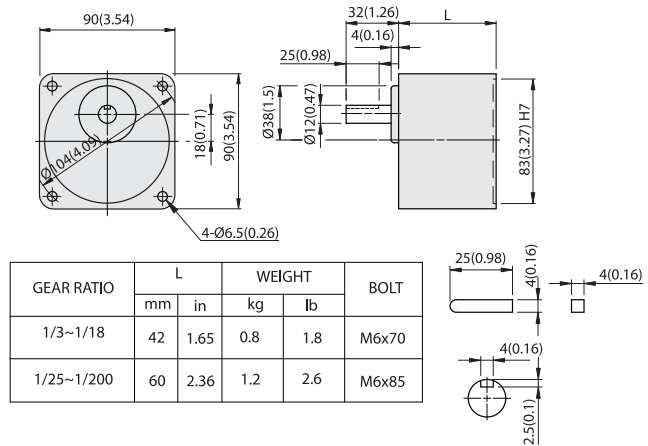

KEY SIZE

[www.MuGuL.com](http://www.MuGuL.com)

##### E9HK□M(B) + E9R40P□LE

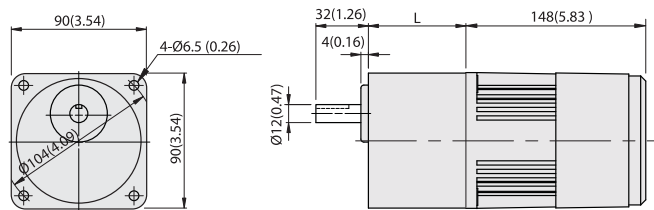

### RATED TORQUE OF GEARHEAD

MODEL	Speed(rpm)	500	300	200	120	100	60	50	30	20	15	10	9	
		Ratio	50Hz	3	5	7.5	12.5	15	25	30	50	75	100	150
		60Hz	3.6	6	9	15	18	30	36	60	90	120	180	200
E9HK□M E9HK□B		kg-cm	7.3	12.2	18.2	30.4	36.5	54.8	65.7	99.0	100	100	100	100
		N-m	0.71	1.19	1.79	2.98	3.57	5.37	6.44	9.70	9.80	9.80	9.80	9.80
		oz-in	101	169	253	422	506	760	912	1375	1389	1389	1389	1389

- \* The normal torque is that the motor and gearhead are directly coupled.
- \* Insert the denominator of reduction ratio in □ of gearhead model name.
- \* Actual rotation speed is 2~15% less than synchronous speed.
- \* ■ Color indicates that the rotation of gearhead shaft is in opposite direction as output shaft of motor.