

Planetary gearbox motor

Picture of Products

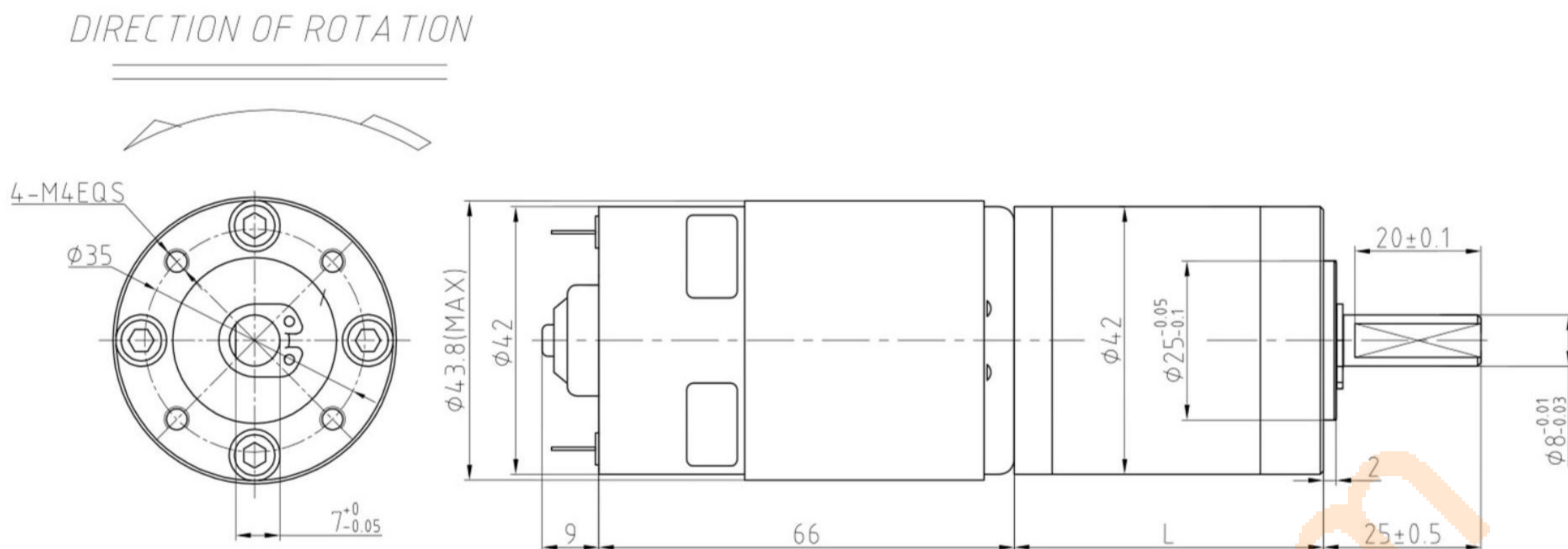

Outline Dimensions(mm)



DC Motor Technical Data

Model	Rated Voltage (V)	No-Load Parameters		Rated Parameters					Stall
		Speed	Current	Speed	Current	Torque	Output	eff	Torque
		rpm	mA	rpm	A	mN.m	W	%	mN.m
RS775	12	7000	760	5600	2.81	38.00	22.28	66.16	114.00
RS775	24	6500	400	5200	1.46	41.00	22.32	63.78	123.00

DC Motor With Gearbox Technical Data

RS775-12V-7000R DC MOTOR

Reduction Ratio	5.2	13.7	26.9	71	139	512	1367
Number of gear trains	1	2	2	3	3	4	5
Length of gearbox (MM)	29	38.7	38.7	49.4	49.4	61.6	73.8
No-load speed (RPM)	1346	511	260	98.6	50.4	13.7	5.12
Rated speed (RPM)	1077	409	208	78.9	40.3	10.9	4.1
Rated torque (N.m)	0.18	0.42	0.83	1.97	3.85	12.77	25.00
Max permissible torque (N.m)	0.53	1.27	2.48	5.90	11.55	25.00	25.00

RS775-24V-6500R DC MOTOR

Reduction Ratio	5.2	13.7	26.9	71	139	512	1367
Number of gear trains	1	2	2	3	3	4	5
Length of gearbox (MM)	29	38.7	38.7	49.4	49.4	61.6	73.8
No-load speed (RPM)	1250	474	242	91.5	46.8	12.7	4.75
Rated speed (RPM)	1000	380	193	73.2	37.4	10.2	3.8
Rated torque (N.m)	0.19	0.45	0.89	2.12	4.15	13.77	25.00
Max permissible torque (N.m)	0.58	1.36	2.68	6.37	12.46	25.00	25.00